



**Appendix A14.1**  
Scheme Walkover  
Summary

## **Contents**

<b>Appendix A14.1: Scheme Walkover Summary .....</b>	<b>1</b>
1.1 Introduction.....	1
1.2 Summary .....	2
1.3 Photos.....	3

## **Appendix A14.1: Scheme Walkover Summary**

### **1.1 Introduction**

The following is a summary of the observations by the Land, Soils, Geology and Hydrogeology Environmental Impact Assessment Team following a physical walkover of the Proposed Scheme. The walkover occurred on 19 February 2020, 7 July 2021 and 13<sup>th</sup> March 2023.

Not all observations have been included in this summary for conciseness. Typically, only observations that could not have been determined from a desk study and that are relevant to the land, soils, geology and hydrogeology chapter have been included. The omission of an observation or a feature does not negate the feature's importance in terms of the Land, Soils, Geology and Hydrogeology environmental impact assessment.

The observations are summarised in Table 1 and the corresponding photos in Table 2.

## 1.2 Summary

**Table 1: Scheme Walkover Summary**

Observation	Consultation Drawing Sheet Number	Description	Possible Impact	Photo
Petrol Station	Sheets01	Historic activities at petrol stations may have resulted in oil leaks into the surrounding soils and groundwater in the past.	This may pose an issue for the earthworks balance and waste assessment	Kimage_Image01
Urban Green Area and existing walls	Sheet 01	There is a level change noted in the green area.	This may pose an issue for the earthworks balance and waste assessment	Kimage_Image02
Petrol Station	Sheet 02	Historic activities at petrol stations may have resulted in oil leaks into the surrounding soils and groundwater in the past.	This may pose an issue for the earthworks balance and waste assessment	Kimage_Image03
Possible interaction with the River Dodder	Sheet 03	There is a potential for the Proposed Scheme to interact with the local waterbody during the development of the Stoneboat Boardwalk for the Poddle cycleway.	This may pose an issue if a localized contamination source is identified.	Kimage_Image04 & 05
Potential Construction Compound	Sheet 07	Proposed location for a construction compound at Our Lady's Hospice – Harold's Cross Road. It is likely that the topsoil will be stripped, and level changes will be required at this location to accommodate the construction compound.	This may pose an issue for the earthworks balance and waste assessment	Kimage_Image06
Proposed land acquisition	Sheet 07	Proposed land acquisition along Harolds Cross Road on both sides of the carriageway. Minor level changes noted in the area	This may pose an issue for the earthworks balance and waste assessment	Kimage_Image07
Proposed new pedestrian and cycle bridge over Grand Canal	Sheet 08	There is an existing retaining wall which separates the carpark from the existing road level. There is proposed road widening in this area. There is a potential for the Proposed Scheme to interact with the local waterbody.	This may pose an issue for the earthworks balance and waste assessment and may pose an issue if a localized contamination source is identified.	Kimage_Image08 & 09
Construction Compounds	Sheet 09	Possible location for a construction compound at St Patrick's Court – Clanbrassil Street Lower.Road. It is likely that the topsoil will be stripped, and level changes will be required at this location to accommodate the construction compound.	This may pose an issue for the earthworks balance and waste assessment.	Kimage_Image_10



### 1.3 Photos

Table 2: Scheme Walkover Photos

Photo ID	Caption	Date Taken	Coordinates
Kimmage_Image01	Potential interaction with service station at junction	13/03/2023	713310, 730457 (ITM)



Key plan

 Circle denotes approximate location of photo  
 with triangle denoting approximate direction of photo

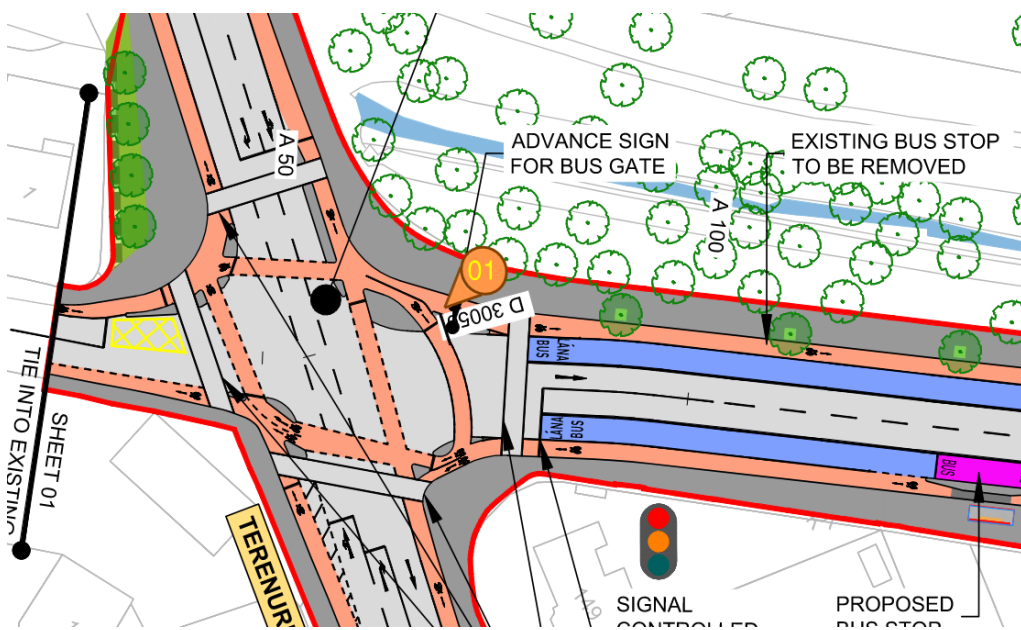

Photo ID	Caption	Date Taken	Coordinates
Kimmage_Image02	Potential level change	13/03/2023	713415, 730585 (ITM)



Key plan

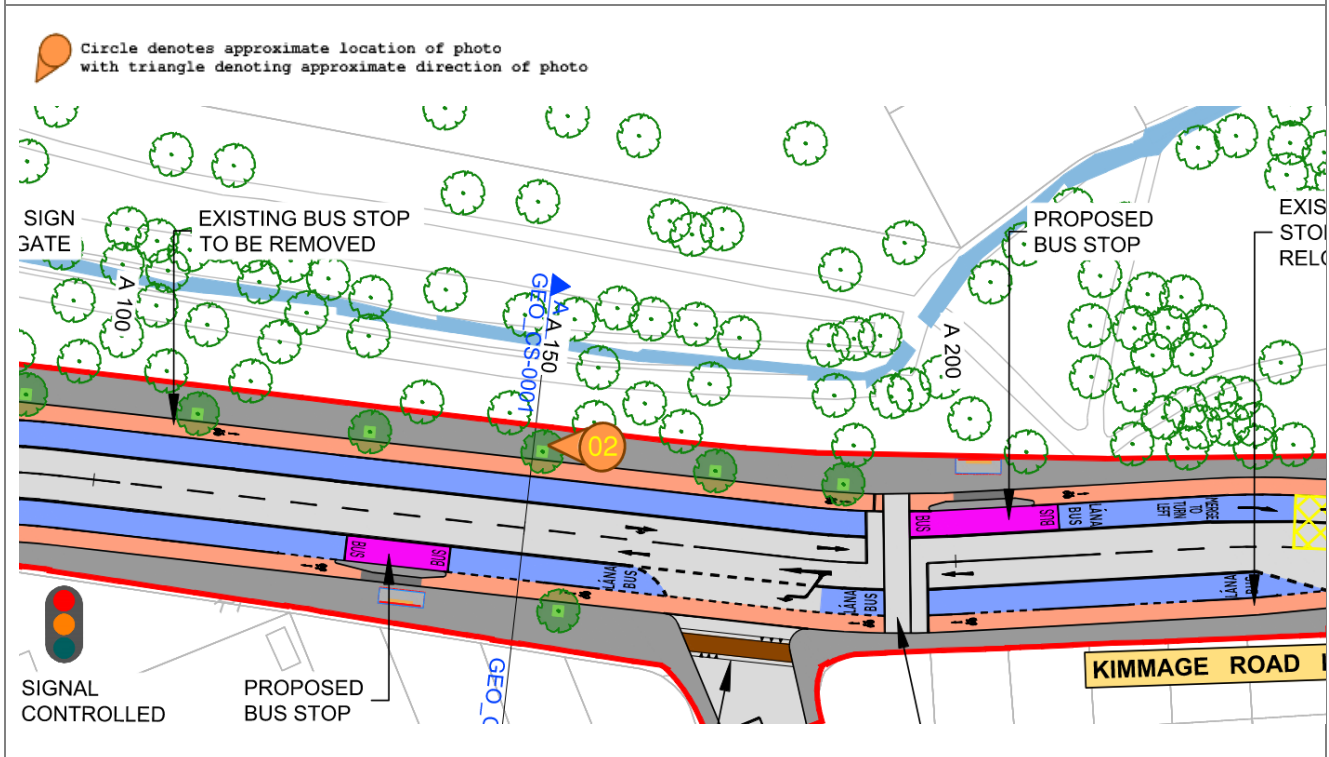



Photo ID	Caption	Date Taken	Coordinates
Kimmage_Image3	Potential interactions with service station along Kimmage Road Lower	13/03/2023	713655, 730932 (ITM)



Key plan

 Circle denotes approximate location of photo  
 with triangle denoting approximate direction of photo

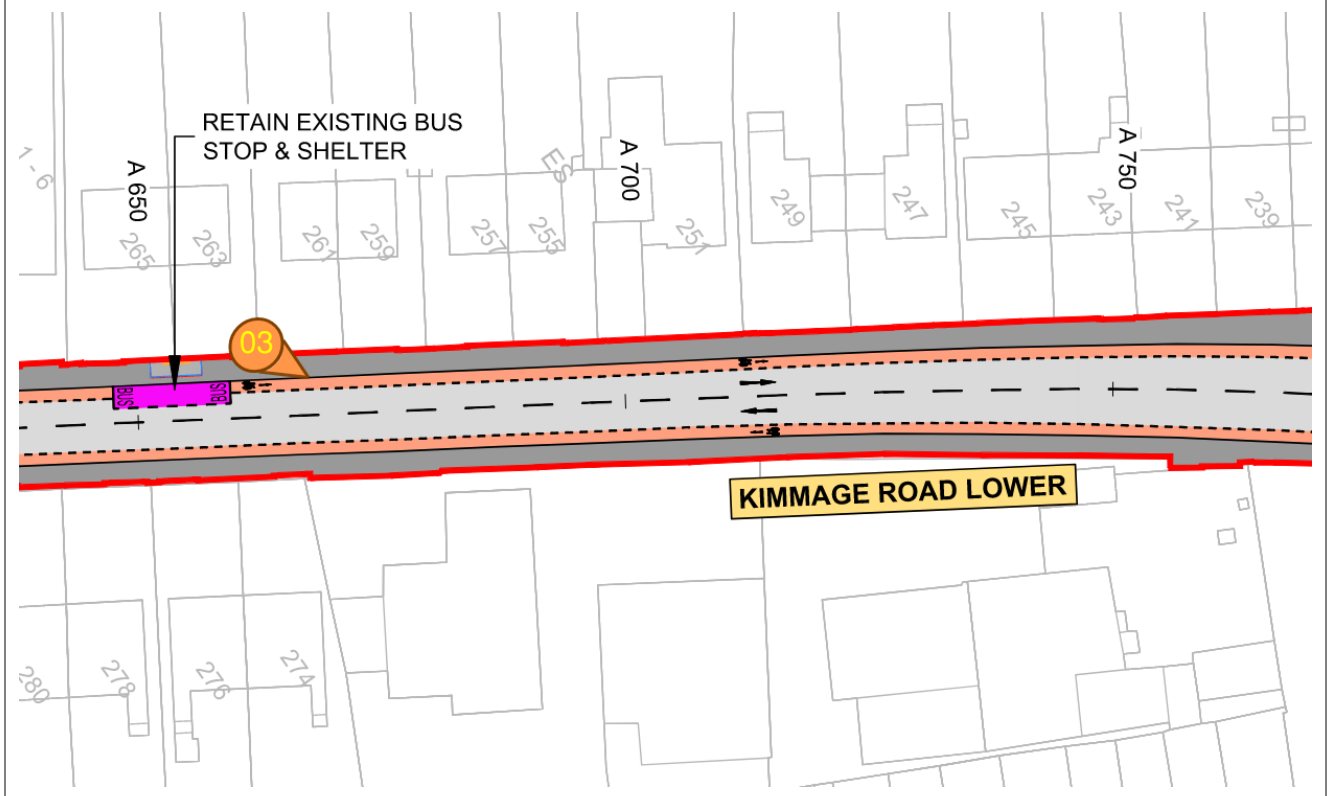



Photo ID	Caption	Date Taken	Coordinates
Kimmage_Image04	Potential location for the Poddle cycle way	13/02/20 20	713842, 731338 (ITM)



Key plan

 Circle denotes approximate location of photo  
 with triangle denoting approximate direction of photo

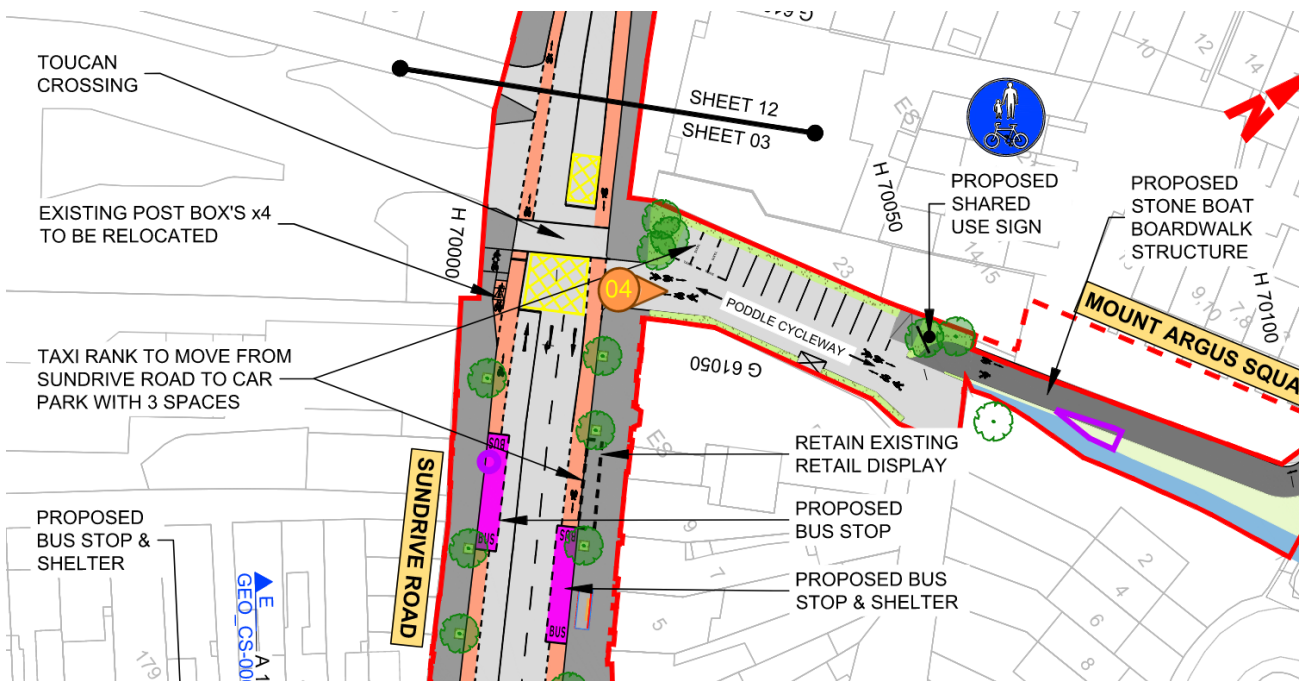



Photo ID	Caption	Date Taken	Coordinates
Kimmage_Image05	Potential location of proposed stone boat boardwalk	13/03/2023	713903, 731378 (ITM)



Key plan

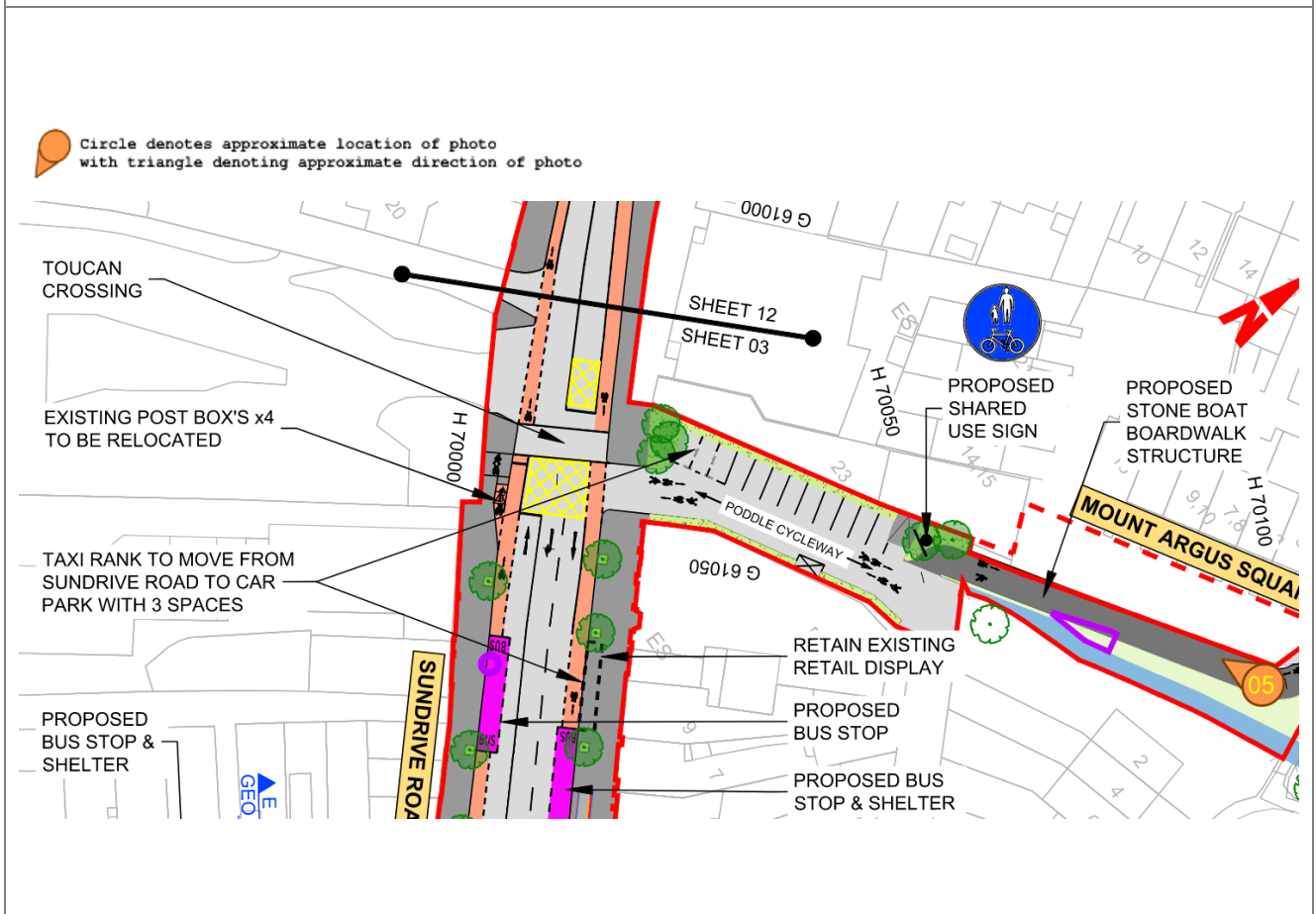

Photo ID	Caption	Date Taken	Coordinates
Kimmage_Image_06	Proposed location for a construction compound at Our Lady's Hospice – Harold's Cross Road	07/07/2021	714708, 732129 (ITM)



Key plan

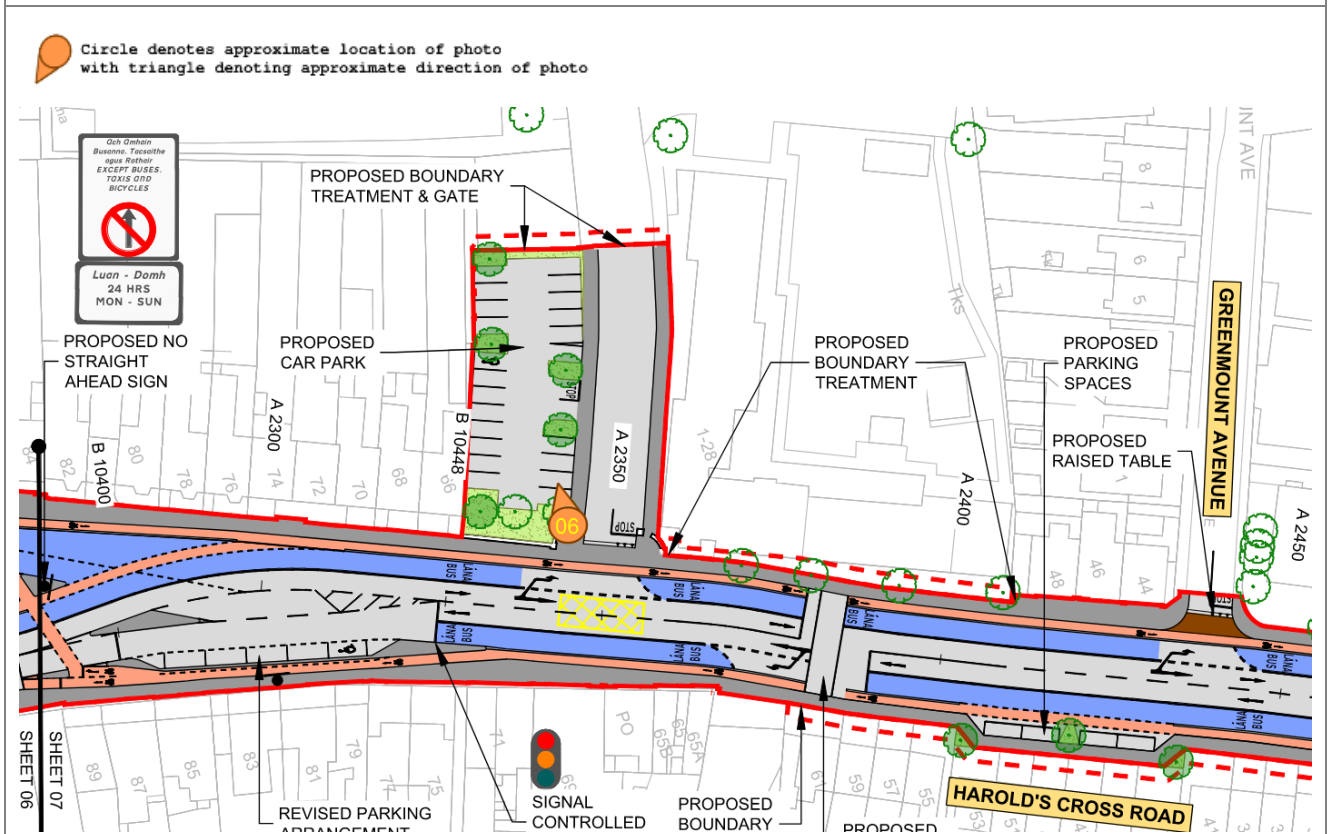

Photo ID	Caption	Date Taken	Coordinates
Kimmage_Image_07	Proposed land acquisition along Harolds Cross Road	13/03/2023	714726, 732134 (ITM)



Key plan

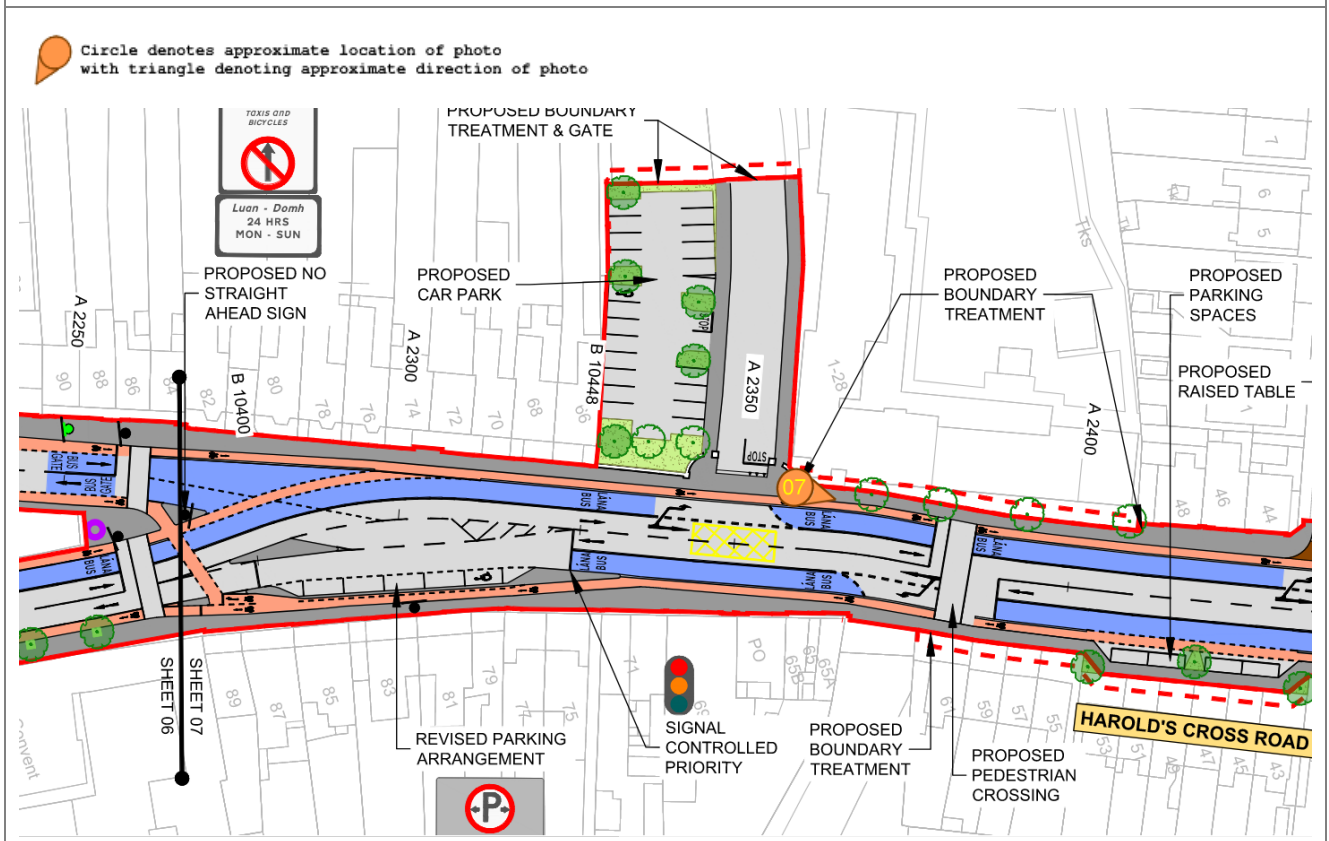



Photo ID	Caption	Date Taken	Coordinates
Kimmage_Image_09	Proposed new pedestrian and cycle bridge	13/03/2023	714867, 732512 (ITM)



Key plan

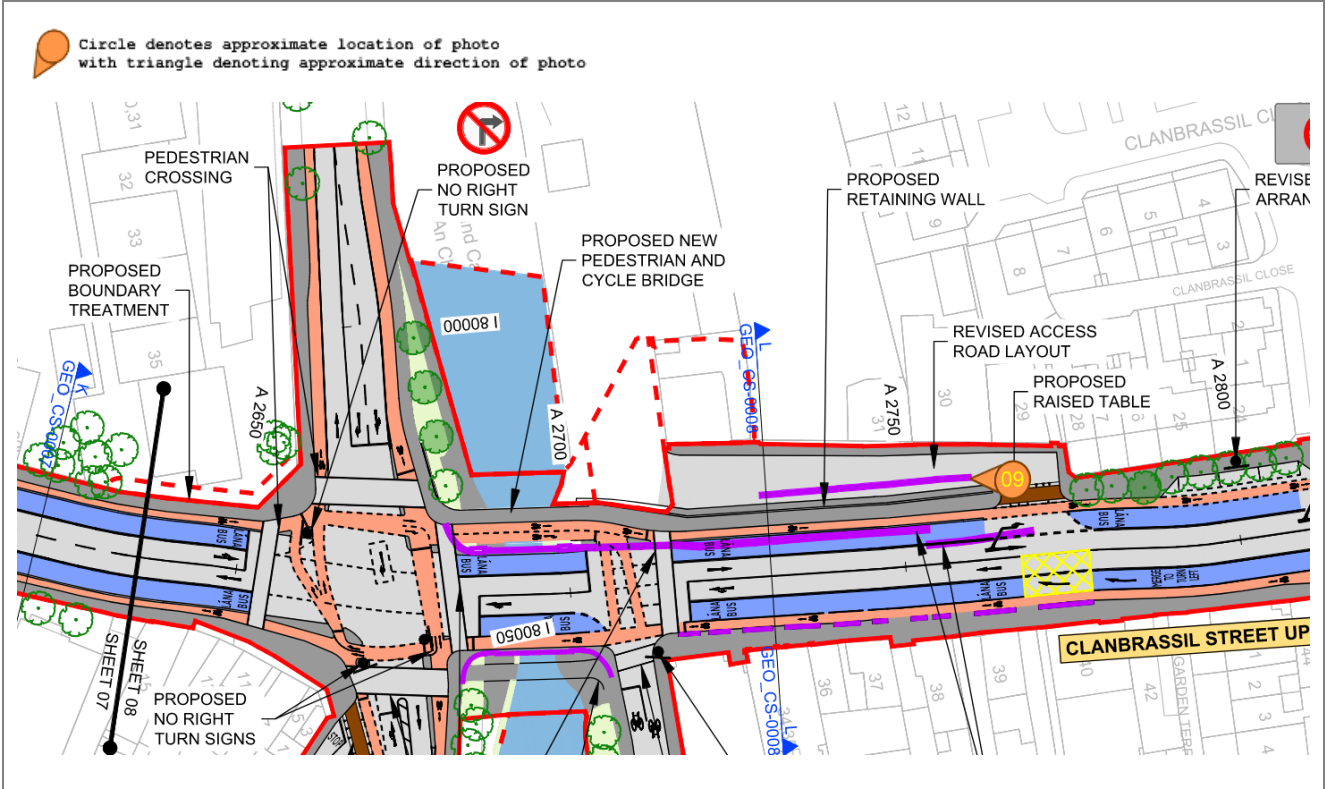

Photo ID	Caption	Date Taken	Coordinates
Kimmage_Image_10	Possible location of a construction compound at St Patrick's Court – Clanbrassil Street Lower.	07/07/2021	714888, 732937 (ITM)



Key plan

